

**LANDSCAPE SPECIFICATIONS:**

- The Landscape Contractor is responsible for all materials and all work as called for on the Landscape/Planting Plans and in the Plant List and Specifications. The Plant List quantities shall be used as a guide only. The Landscape Contractor shall verify all quantities and report any discrepancies to Redmon Design Company (RDC) at time of bidding.
- RDC is to be notified at least two days prior to installation of any and all plants. The Landscape Architect is to be present before plants are installed. The Landscape Architect will stake tree locations and mark bed lines at time of installation unless RDC notifies the Landscape Contractor otherwise.
- All plants shall be graded Florida No. 1 or better as outlined under Grades and Standards for Nursery Plants, Division of Plant Industry, State of Florida. Palms should be graded Florida Fancy.
- The Landscape Contractor shall review architectural engineering plans and become thoroughly familiar with surface and subsurface utilities.
- The Landscape Contractor shall coordinate with other trades to prevent conflicts, and shall coordinate the planting with the irrigation work to assure availability and proper location of irrigation items.
- Every possible safeguard shall be taken to protect building surfaces, equipment and furnishings. The Landscape Contractor shall be responsible for any damage or injury to person or property, which may occur as a result of negligence in the execution of the work.
- The Landscape Contractor shall be wholly responsible for stability and plumb condition of all trees and shrubs and be legally liable for any damage caused by instability of any plants.
- The Landscape Contractor shall determine trees or shrubs need to be staked or guyed. If necessary, guying and staking shall be done by a method approved by RDC prior to installation. It shall be the responsibility of the Landscape Contractor to remove guys and stakes after new root growth is firmly established.
- The Landscape Contractor shall completely remove all burlap prior to installation.
- The Landscape Contractor shall insure that his work does not interrupt established or projected drainage patterns.
- The Landscape Contractor shall insure adequate vertical drainage in all plant beds, planters and sod areas.
- Sod: All sod shall be recognized Zoysia. Sod shall be free of weeds at time of installation. It shall be the responsibility of the Landscape Contractor to measure and determine the exact amount required.
- Mulch: All plants shall be dressed with 2"-3" pine bark. NO CYPRESS MULCH!

**Guarantee:** All plants, except sod and palms, shall be guaranteed for 180 days from the time of inspection. Palms shall be guaranteed for one year from the date of final inspection. Sod shall be guaranteed for 90 days from final inspection. All plants shall be alive and in satisfactory growth for each specific kind of plant at the end of the guarantee period.

F

E

D

C

B

A

LOT 1  
PALM SPRINGS GARDEN APARTMENTS  
PLAT BOOK 23, PAGE 12  
ONIC-BOCA CLUB LLC  
PARCEL ID: 33-22-29-6567-00-010

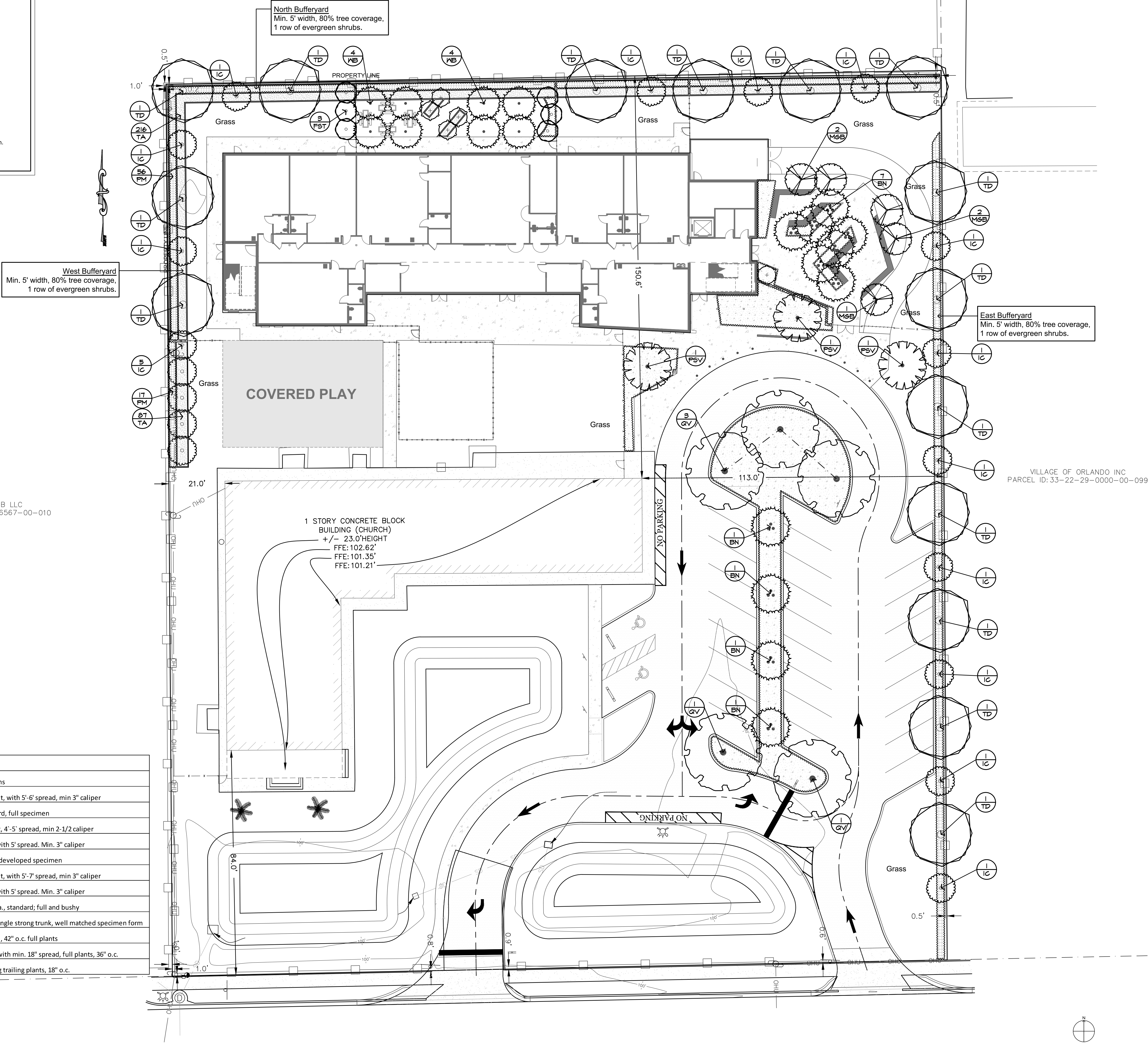

**LITTLE**  
DIVERSED ARCHITECTURAL CONSULTING

[www.littleonline.com](http://www.littleonline.com)

This drawing and the design shown are the property of Little Diverseid Architectural Consulting. The reproduction, copying or other use of this drawing without their written consent is prohibited and any infringement will be subject to legal action.

© Little 2022

**Legends Academy**  
Tomorrow's Leaders

**REDMON DESIGN COMPANY**  
Landscape Architecture  
Planning  
407 • 647 • 2006  
92 S Lakewood Circle  
Maitland, FL 32751  
RedmonDesign.com

PRELIMINARY  
NOT FOR  
CONSTRUCTION

NOT FOR CONSTRUCTION

DESIGN DEVELOPMENT

02/14/2021

NO. REASON DATE

PRINCIPAL IN CHARGE

SCOTT REDMON

PROJECT MANAGER

BG

DESIGN TEAM

SR

LEGENDS ACADEMY - ES  
(NEW CONSTRUCTION)

3009 ORANGE CENTER  
BLVD.  
ORLANDO, FL 32805

814C266375

CONCEPTUAL  
LANDSCAPE  
PLAN

L1

COPYRIGHT 2025 BY REDMON DESIGN CO., P.A.  
THIS DRAWING IS PROTECTED BY COPYRIGHT OF  
THE UNITED STATES. NO PART OF THIS DESIGN  
OR THE DOCUMENT, INCLUDING ELECTRONIC  
MEDIA, MAY BE REPRODUCED, TRANSMITTED,  
COPIED, OR OTHERWISE USED FOR ANY PURPOSE  
WITHOUT THE EXPRESS WRITTEN CONSENT OF THE  
LANDSCAPE ARCHITECT.

NOT FOR CONSTRUCTION